

NOTICE!!

These documents have been scanned!

Do not place un-scanned documents beneath this notice!

Do not remove this notice from this file!

GPO Jacket No. 560-102
Print Order 61540
Rise Business Services, LLC
Job=AZ15 5/2/2019



Box Number= AZ15017



Claim Begin-End: AMC438326-AMC438326

1 Initial Receipt



AZ15017-24

AMC437915-AMC438337

**United States Department of the Interior
Bureau of Land Management**

DIV OF LANDS, MINRLS & ENERGY
ONE N CENTRAL AVE
PHOENIX, AZ 85004 -4427
Phone: 602-417-9200

Receipt

No: 3564552

Transaction #: 3667340	
Date of Transaction: 05/20/2016	
CUSTOMER:	
	GRE INC 2091 E MURRAY HOLLADAY RD STE SALT LAKE CITY, UT 84117-5174 US

LINE #	QTY	DESCRIPTION	REMARKS	UNIT PRICE	TOTAL
1	1.00	LOCATABLE MINERALS / MINING CLAIMS- NEW, UNADJUD, ONE OR MORE AUTH NOS / NEW MINING CLAIMS LOCATION FEE CASES: AMC438326/\$37.00		- n/a -	37.00
2	1.00	LOCATABLE MINERALS / MINING CLAIMS- NEW, UNADJUD, ONE OR MORE AUTH NOS / NEW MINING CLAIM PROCESSING FEE CASES: AMC438326/\$20.00		- n/a -	20.00
3	1.00	LOCATABLE MINERALS / MINING CLAIMS- NEW, UNADJUD, ONE OR MORE AUTH NOS / NEW MINING CLAIMS MAINTENANCE FEE CASES: AMC438326/\$155.00		- n/a -	155.00
TOTAL:					\$212.00

PAYMENT INFORMATION			
1	AMOUNT:	212.00	POSTMARKED: N/A
	TYPE:	CHECK	RECEIVED: 05/19/2016
	CHECK NO:	003278	
	NAME:	GRE INC 2091 E MURRAY HOLLADAY RD STE SALT LAKE CITY UT 84117-5174 US	

REMARKS

This receipt was generated by the automated BLM Collections and Billing System and is a paper representation of a portion of the official electronic record contained therein.

NOTICE!!

These documents have been scanned!

Do not place un-scanned documents beneath this notice!

Do not remove this notice from this file!

GPO Jacket No. 560-102
Print Order 61540
Rise Business Services, LLC
Job=AZ15 5/2/2019



Box Number= AZ15017



Claim Begin-End: AMC438326-AMC438326

2 Correspondence



AZ15017-24

AMC437915-AMC438337

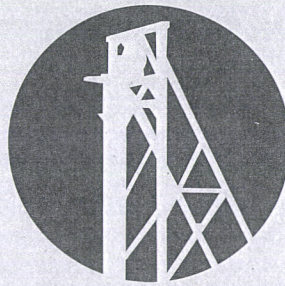

GOLD RUSH EXPEDITIONS

437130

437132

437935

438326

11/15/2017

439949

440223

440245

440367

440526

440552

441034

441153

442189

443322

PHOENIX, ARIZONA

2017 NOV 20 P 2:31

RECEIVED
BLM AZ STATE OFFICE

GRE, Inc.
331 S. Rio Grande Street
Suite #201
SLC, UT 84101

Arizona BLM

Re: Change of Address

Dear Arizona BLM,

Please make a note that GRE Inc. Office has moved. Please change our address to the following

GRE, Inc.
331 S. Rio Grande Street
Suite #201
SLC, UT 84101

443510

444671

We have the following claims

- FESTERLING, AMC437130
- HILLTOP, AMC437134
- MORNING STAR, AMC437935
- BLACK GOLD, AMC438326
- FLAG, AMC439949
- C.O.D., AMC440223
- ARIZONA RAND, AMC440245
- RAWHIDE, AMC440367
- RAWHIDE EXTENSION, AMC440368
- GIBSON EXTENSION, AMC440532
- HOSEY, AMC440534
- JIMMIE, AMC440536
- LUCKY BOY, AMC440538
- MICA GIANT, AMC440539
- NEW STANDARD, AMC440540
- NEW STANDARD EXT, AMC440541

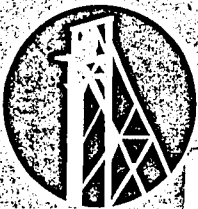

GOLD RUSH

GRE Inc.
331 S. RIO GRANDE ST
SUITE #201
SLC, UT 84101

Arizona BLM
Attn: Cashier
One N. Central Ave., Ste. 800
Phoenix, AZ 85004



U.S. POSTAGE
FIRST CLASS
062900901346
FROM 84117
NOV 20 2011

RECEIVED
BLM STATE OFFICE
2011 NOV 20 P 2:31
PHOENIX, ARIZONA

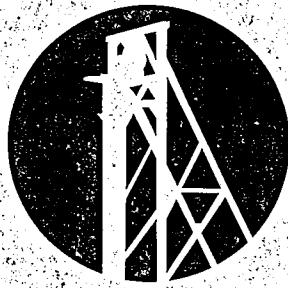

GOLD RUSH EXPEDITIONS

ST LOUIS, AMC440544
TELLURIDE CHIEF, AMC440545
TWILIGHT ZONE, AMC440547
VERDE COMBINATION, AMC440548
YELLOW BREAST, AMC440549
GOLDEN BELT, AMC440552
GOLDEN TURKEY, AMC440553
BULL CANYON, AMC441034
APEX, AMC441153
GREEN STREAK, AMC441154
TALLEY, AMC441155
BLACK MOUNTAIN, AMC442189
CARMELITA, AMC442190
FOUR PEAKS, AMC442191
FOUR PEAKS EXT, AMC442192
GREAT BEAR, AMC442193
JASPER, AMC442194
AGATE AND PALM, AMC443322
ALASKAN, AMC443323
ARRASTRA, AMC443324
ARRASTRA, AMC443325
COPPER QUEEN, AMC443326
PLAMOSA, AMC443330
TEXAS QUEEN, AMC443331
AMBASSADOR, AMC443510
RADIO, AMC443511
UNITED STATES, AMC443512
CARMELITA 1, AMC444671
CARMELITA 2, AMC444672

Thank you for your time and efforts.

Sincerely,

GRE Accounting
385-218-2138
accounting@goldrushexpeditions.com
www.goldrushexpeditions.com

PHOENIX, ARIZONA

2011 NOV 20 P 2:31

RECEIVED
BEM AZ STATE OFFICE

NOTICE!!

These documents have been scanned!

Do not place un-scanned documents beneath this notice!

Do not remove this notice from this file!

GPO Jacket No. 560-102
Print Order 61540
Rise Business Services, LLC
Job=AZ15 5/2/2019



Box Number= AZ15017



Claim Begin-End: AMC438326-AMC438326

3 Transfers



AZ15017-24

AMC437915-AMC438337

**NO
DOCUMENTS
FOUND**

NO DOCUMENTS FOUND
NO DOCUMENTS FOUND

NOTICE!!

These documents have been scanned!

Do not place un-scanned documents beneath this notice!

Do not remove this notice from this file!

GPO Jacket No. 560-102
Print Order 61540
Rise Business Services, LLC
Job=AZ15 5/2/2019



Box Number= AZ15017



Claim Begin-End: AMC438326-AMC438326

4 Annual Filings



AZ15017-24

AMC437915-AMC438337

**DEPARTMENT OF THE INTERIOR
BUREAU OF LAND MANAGEMENT
MINING CLAIMS**

Run Date/Time: 8/27/2019

**MC Maintenance Fees Paid Through the BLM Pay Portal
(by Date Paid)**

Page 73 Of 216

CBS Receipt: 4539324

Printed For Lead File # AMC438326

Agency Tracking ID: 1566404593

Assessment Year: 2020

Number of BLM Serial Nr: 44

Paid On: 8/21/2019

Total Amount Paid: \$7,260.00

Claim Name	BLM Serial No	Lead File No	Amount Paid
BLACK GOLD	AMC438326	AMC438326	\$165.00
FLAG	AMC439949	AMC439949	\$165.00
C.O.D.	AMC440223	AMC440223	\$165.00
ARIZONA RAND	AMC440245	AMC440245	\$165.00
JIMMIE	AMC440536	AMC440526	\$165.00
LUCKY BOY	AMC440538	AMC440526	\$165.00
NEW STANDARD	AMC440540	AMC440526	\$165.00
NEW STANDARD EXT	AMC440541	AMC440526	\$165.00
TELLURIDE CHIEF	AMC440545	AMC440526	\$165.00
VERDE COMBINATION	AMC440548	AMC440526	\$165.00
YELLOW BREAST	AMC440549	AMC440526	\$165.00
GOLDEN TURKEY	AMC440553	AMC440552	\$165.00
APEX	AMC441153	AMC441153	\$165.00
GREEN STREAK	AMC441154	AMC441153	\$165.00
CARMELITA	AMC442190	AMC442189	\$165.00
FOUR PEAKS	AMC442191	AMC442189	\$165.00
FOUR PEAKS EXT	AMC442192	AMC442189	\$165.00
GREAT BEAR	AMC442193	AMC442189	\$165.00
JASPER	AMC442194	AMC442189	\$165.00
ALASKAN	AMC443323	AMC443322	\$165.00
CARMELITA 1	AMC444671	AMC444671	\$165.00
CARMELITA 2	AMC444672	AMC444671	\$165.00
GOLDEN TURKEY 1	AMC447861	AMC447861	\$165.00
GOLDEN TURKEY 2	AMC447862	AMC447861	\$165.00

NO WARRANTY IS MADE BY BLM FOR USE OF THE DATA FOR PURPOSES NOT INTENDED BY BLM

**DEPARTMENT OF THE INTERIOR
BUREAU OF LAND MANAGEMENT
MINING CLAIMS**

Run Date/Time: 8/27/2019

**MC Maintenance Fees Paid Through the BLM Pay Portal
(by Date Paid)**

Page 74 Of 216

NEW STANDARD 1	AMC451012	AMC451012	\$165.00
MONTE CRISTO	AMC453842	AMC453842	\$165.00
COD 2	AMC454379	AMC454379	\$165.00
COD 3	AMC454380	AMC454379	\$165.00
COD 4	AMC454381	AMC454379	\$165.00
COD 5	AMC454382	AMC454379	\$165.00
COD 6	AMC454383	AMC454379	\$165.00
COD 7	AMC454384	AMC454379	\$165.00
COD 8	AMC454385	AMC454379	\$165.00
COD 9	AMC454386	AMC454379	\$165.00
COD 10	AMC454387	AMC454379	\$165.00
DIPLOMAT	AMC455006	AMC455006	\$165.00
GOLD BASIN 1	AMC455007	AMC455006	\$165.00
GOLD BASIN 2	AMC455008	AMC455006	\$165.00
GOLD BASIN 3	AMC455009	AMC455006	\$165.00
GOLD BASIN 4	AMC455010	AMC455006	\$165.00
KENTUCKY	AMC455011	AMC455006	\$165.00
SAN FRANCISCO 1	AMC455012	AMC455006	\$165.00
SAN FRANCISCO 2	AMC455013	AMC455006	\$165.00
SAN FRANCISCO 3	AMC455014	AMC455006	\$165.00

United States Department of the Interior
Bureau of Land Management
 BUSINESS & SUPPORT SVCS DIV
 ONE N CENTRAL AVE SUITE 800
 PHOENIX, AZ 85004 -4427
 Phone: 602-417-9200

Receipt	
No:	4539324

Transaction #: 4660270	
Date of Transaction: 08/21/2019	
CUSTOMER:	
JESSICA M SHUMAN 1995 RIVER RUN DRIVE HUNTSVILLE,UT 84317 US	

LINE #	QTY	DESCRIPTION	REMARKS	UNIT PRICE	TOTAL
1	1.00	LOCATABLE MINERALS / MINING CLAIMS- NOT NEW-UNADJUD,ONE AUTH NO. ONLY / MINING CLAIM MONEY RECEIVED CASES: AMC438326/\$7260.00		- n/a -	7260.00
TOTAL:					\$7,260.00

PAYMENT INFORMATION			
NOTE: Items will appear on credit card statement as "BLM O Mining Claim".			
1	AMOUNT:	7260.00	POSTMARKED: N/A
	TYPE:	CREDIT CARD	RECEIVED: 08/21/2019
	NAME:	JESSICA M SHUMAN 1995 RIVER RUN DRIVE HUNTSVILLE UT 84317 US	
	CARD NO:	XXXXXXXXXXXX1140	AUTH CODE: 002420
	NAME ON CARD:	JESSICA M SHUMAN	
	SIGNATURE:	INTERNET	

REMARKS

This receipt was generated by the automated BLM Collections and Billing System and is a paper representation of a portion of the official electronic record contained therein.

**DEPARTMENT OF THE INTERIOR
BUREAU OF LAND MANAGEMENT
MINING CLAIMS**

Run Date/Time: 9/11/2018

MC Maintenance Fees Paid Through the BLM Pay Portal
(by Date Paid)

Page 358 Of 723

CBS Receipt: 4248102

Printed For Lead File # **AMC438326**

Agency Tracking ID: 1535477873

Assessment Year: 2019

Paid On: 8/28/2018

Number of BLM Serial Nr: 29

Total Amount Paid: \$4,495.00

Claim Name	BLM Serial No	Lead File No	Amount Paid
BLACK GOLD	AMC438326	AMC438326	\$155.00
FLAG	AMC439949	AMC439949	\$155.00
C.O.D.	AMC440223	AMC440223	\$155.00
ARIZONA RAND	AMC440245	AMC440245	\$155.00
JIMMIE	AMC440536	AMC440526	\$155.00
LUCKY BOY	AMC440538	AMC440526	\$155.00
NEW STANDARD	AMC440540	AMC440526	\$155.00
NEW STANDARD EXT	AMC440541	AMC440526	\$155.00
ST LOUIS	AMC440544	AMC440526	\$155.00
TELLURIDE CHIEF	AMC440545	AMC440526	\$155.00
VERDE COMBINATION	AMC440548	AMC440526	\$155.00
YELLOW BREAST	AMC440549	AMC440526	\$155.00
GOLDEN BELT	AMC440552	AMC440552	\$155.00
GOLDEN TURKEY	AMC440553	AMC440552	\$155.00
APEX	AMC441153	AMC441153	\$155.00
GREEN STREAK	AMC441154	AMC441153	\$155.00
TALLEY	AMC441155	AMC441153	\$155.00
CARMELITA	AMC442190	AMC442189	\$155.00
FOUR PEAKS	AMC442191	AMC442189	\$155.00
FOUR PEAKS EXT	AMC442192	AMC442189	\$155.00
GREAT BEAR	AMC442193	AMC442189	\$155.00
JASPER	AMC442194	AMC442189	\$155.00
ALASKAN	AMC443323	AMC443322	\$155.00
PLAMOSA	AMC443330	AMC443322	\$155.00

NO WARRANTY IS MADE BY BLM FOR USE OF THE DATA FOR PURPOSES NOT INTENDED BY BLM

DEPARTMENT OF THE INTERIOR
BUREAU OF LAND MANAGEMENT
MINING CLAIMS

Run Date/Time: 9/11/2018

MC Maintenance Fees Paid Through the BLM Pay Portal
(by Date Paid)

Page 359 Of 723

CARMELITA 1	AMC444671	AMC444671	\$155.00
CARMELITA 2	AMC444672	AMC444671	\$155.00
GOLDEN TURKEY 1	AMC447861	AMC447861	\$155.00
GOLDEN TURKEY 2	AMC447862	AMC447861	\$155.00
NEW STANDARD 1	AMC451012	AMC451012	\$155.00

United States Department of the Interior
Bureau of Land Management
 BUSINESS & SUPPORT SVCS DIV
 ONE N CENTRAL AVE SUITE 800
 PHOENIX, AZ 85004 -4427
 Phone: 602-417-9200

Receipt

No: 4248102

Transaction #: 4363576	
Date of Transaction: 08/28/2018	
CUSTOMER:	
JESSICA SHUMAN 1995 RIVER RUN DRIVE HUNTSVILLE,CT 84317 US	

LINE #	QTY	DESCRIPTION	REMARKS	UNIT PRICE	TOTAL
1	1.00	LOCATABLE MINERALS / MINING CLAIMS- NOT NEW-UNADJUD, ONE AUTH NO. ONLY / MINING CLAIM MONEY RECEIVED CASES: AMC439949/\$4495.00		- n/a -	4495.00
TOTAL:					\$4,495.00

PAYMENT INFORMATION					
NOTE: Items will appear on credit card statement as "BLM O Mining Claim".					
1	AMOUNT:	4495.00	POSTMARKED:	N/A	
	TYPE:	CREDIT CARD	RECEIVED:	08/28/2018	
	NAME:	JESSICA SHUMAN 1995 RIVER RUN DRIVE HUNTSVILLE CT 84317 US			
	CARD NO:	XXXXXXXXXXXX3699	AUTH CODE:	029750	
	NAME ON CARD:	JESSICA SHUMAN			
	SIGNATURE:				

REMARKS

This receipt was generated by the automated BLM Collections and Billing System and is a paper representation of a portion of the official electronic record contained therein.

**DEPARTMENT OF THE INTERIOR
BUREAU OF LAND MANAGEMENT
MINING CLAIMS**

MC Maintenance Fees Paid Through the BLM Pay Portal

CBS Receipt: 3917326

Printed For Lead File # AMC438326

Agency Tracking ID: 1501613952

Number of BLM Serial Nr: 24

Assessment Year: 2018

Total Amount Paid: \$3,720.00

Paid On: 08/01/2017

Claim Name	BLM Serial No	Lead File No	Amount Paid
BLACK GOLD	AMC438326	AMC438326	\$155.00
ARIZONA RAND	AMC440245	AMC440245	\$155.00
GIBSON EXTENSION	AMC440532	AMC440526	\$155.00
NEW STANDARD	AMC440540	AMC440526	\$155.00
NEW STANDARD EXT	AMC440541	AMC440526	\$155.00
ST LOUIS	AMC440544	AMC440526	\$155.00
TELLURIDE CHIEF	AMC440545	AMC440526	\$155.00
TUSCUMBIA	AMC440546	AMC440526	\$155.00
TWILIGHT ZONE	AMC440547	AMC440526	\$155.00
VERDE COMBINATION	AMC440548	AMC440526	\$155.00
YELLOW BREAST	AMC440549	AMC440526	\$155.00
GOLDEN TURKEY	AMC440553	AMC440552	\$155.00
TALLEY	AMC441155	AMC441153	\$155.00
CARMELITA	AMC442190	AMC442189	\$155.00
FOUR PEAKS	AMC442191	AMC442189	\$155.00
FOUR PEAKS EXT	AMC442192	AMC442189	\$155.00
GREAT BEAR	AMC442193	AMC442189	\$155.00
AGATE AND PALM	AMC443322	AMC443322	\$155.00
ALASKAN	AMC443323	AMC443322	\$155.00
GOLD RANGE	AMC443327	AMC443322	\$155.00
RADIO	AMC443511	AMC443510	\$155.00
UNITED STATES	AMC443512	AMC443510	\$155.00
CARMELITA 1	AMC444671	AMC444671	\$155.00
CARMELITA 2	AMC444672	AMC444671	\$155.00

United States Department of the Interior
Bureau of Land Management
 BUSINESS & SUPPORT SVCS DIV
 ONE N CENTRAL AVE SUITE 800
 PHOENIX, AZ 85004 -4427
 Phone: 602-417-9200

Receipt

No: 3917326

Transaction #: 4026792	
Date of Transaction: 08/01/2017	
CUSTOMER:	
CRYSTAL SUTTON 2091 E MURRAY HOLLADAY RD SLC,UT 84117 US	

LINE #	QTY	DESCRIPTION	REMARKS	UNIT PRICE	TOTAL
1	1.00	LOCATABLE MINERALS / MINING CLAIMS- NOT NEW-UNADJUD,ONE AUTH NO. ONLY / MINING CLAIM MONEY RECEIVED CASES: AMC442190/\$3720.00		- n/a -	3720.00
TOTAL:					\$3,720.00

PAYMENT INFORMATION			
NOTE: Items will appear on credit card statement as "BLM O Mining Claim".			
1	AMOUNT:	3720.00	POSTMARKED: N/A
	TYPE:	CREDIT CARD	RECEIVED: 08/01/2017
	NAME:	CRYSTAL SUTTON 2091 E MURRAY HOLLADAY RD SLC UT 84117 US	
	CARD NO:	XXXXXXXXXXXX4138	AUTH CODE: 026942
	NAME ON CARD:	CRYSTAL SUTTON	
	EXPIRES:	12/2019	
	SIGNATURE:		

REMARKS

This receipt was generated by the automated BLM Collections and Billing System and is a paper representation of a portion of the official electronic record contained therein.

Run Date: 09/09/16

Run Time: 05:54 AM

**DEPARTMENT OF THE INTERIOR
BUREAU OF LAND MANAGEMENT
MINING CLAIMS**

MC Maintenance Fees Paid Through the BLM Pay Portal

CBS Receipt: 3638893

Printed For Lead File # **AMC438326**

Agency Tracking ID: 1471967092

Assessment Year: 2017

Number of BLM Serial Nr: 4

Paid On: 08/23/2016

Total Amount Paid: \$620.00

Claim Name	BLM Serial No	Lead File No	Amount Paid
FESTERLING	AMC437130	AMC437130	\$155.00
HILLTOP	AMC437134	AMC437132	\$155.00
MORNING STAR	AMC437935	AMC437935	\$155.00
BLACK GOLD	AMC438326	AMC438326	\$155.00

United States Department of the Interior
Bureau of Land Management
 BUSINESS & SUPPORT SVCS DIV
 ONE N CENTRAL AVE SUITE 800
 PHOENIX, AZ 85004 -4427
 Phone: (602) 417-9200

Receipt

No: 3638893

Transaction #: 3742808	
Date of Transaction: 08/23/2016	
CUSTOMER:	
	CRYSTAL SUTTON 2091 E MURRAY HOLLADAY RD SLC,UT 84117 US

LINE #	QTY	DESCRIPTION	REMARKS	UNIT PRICE	TOTAL
1	1.00	LOCATABLE MINERALS / MINING CLAIMS- NOT NEW-UNADJUD,ONE AUTH NO. ONLY / MINING CLAIM MONEY RECEIVED CASES: AMC437134/\$620.00		- n/a -	620.00
TOTAL:					\$620.00

PAYMENT INFORMATION			
NOTE: Items will appear on credit card statement as "BLM O Mining Claim".			
1	AMOUNT:	620.00	POSTMARKED: N/A
	TYPE:	CREDIT CARD	RECEIVED: 08/23/2016
	NAME:	CRYSTAL SUTTON 2091 E MURRAY HOLLADAY RD SLC UT 84117 US	
	CARD NO:	XXXXXXXXXXXX4131	AUTH CODE: 029813
	NAME ON CARD:	CRYSTAL SUTTON	
	EXPIRES:	11/2018	
	SIGNATURE:		

REMARKS

This receipt was generated by the automated BLM Collections and Billing System and is a paper representation of a portion of the official electronic record contained therein.

NOTICE!!

These documents have been scanned!

Do not place un-scanned documents beneath this notice!

Do not remove this notice from this file!

GPO Jacket No. 560-102
Print Order 61540
Rise Business Services, LLC
Job=AZ15 5/2/2019



Box Number= AZ15017



Claim Begin-End: AMC438326-AMC438326

5 Miscellaneous



AZ15017-24

AMC437915-AMC438337

**NO
DOCUMENTS
FOUND**

NO DOCUMENTS FOUND
NO DOCUMENTS FOUND

NOTICE!!

These documents have been scanned!

Do not place un-scanned documents beneath this notice!

Do not remove this notice from this file!

GPO Jacket No. 560-102
Print Order 61540
Rise Business Services, LLC
Job=AZ15 5/2/2019



Box Number= AZ15017



Claim Begin-End: AMC438326-AMC438326

6 Location Notices-Amendments and Supporting Documents



AZ15017-24 AMC437915-AMC438337

MINING CLAIM STATUS REPORT

Data Entered: 24 MAY 14

MTP Checked By: _____

GEO Checked By: _____

LEAD SERIAL NUMBER: AMC 438326 thru AMC _____

NUMBER OF CLAIMS & TYPE:

1 LODE
____ PLACER
____ ASSOCIATION PLACER
____ MILL SITE
____ TUNNEL SITE

CHARGES:

Location Fee @ \$37 = \$ 37.00
Processing Fee @ \$20 = \$ 20.00
Maintenance Fee @ \$155 = \$ 155.00
Add'l Maint Fee for Assoc Placer = \$ _____
SUBTOTAL \$ 212.00
Other Fees \$ _____
Other Fees \$ _____
TOTAL \$ 212.00

TOTAL ACREAGE: N/A Per Claim
(Placer Only)

NUMBER OF LOCATORS: 1

DOCUMENTS RECEIVED VIA : Over-the-Counter [] Mail [] **TIMELY FILED:** Yes [] No []

LEGAL DESCRIPTION: T 23S R 25E SEC 21
T _____ R _____ SEC _____
T _____ R _____ SEC _____
T _____ R _____ SEC _____
T _____ R _____ SEC _____

BLM [] FOREST SERVICE [] _____ SUBJ TO PL 359: Yes [] No []
WILDERNESS AREA [] _____

SPLIT ESTATE: N/A [] SX [] PX [] OTHER [] _____
SRHA [] Was proper Notice filed if located on SHRA Land? Yes [] No []

RECONVEYED MINERALS ON BLM LAND REQUIRE OPENING ORDER FROM 1944 TO 1993:

Open to Entry On _____ N/A []

COMMENTS/STATUS: VOID [] PARTIALLY VOID [] PVT MINERALS [] WITHDRAWN LANDS []
OTHER [] _____

[] Claimant acknowledges that portions of the following claim(s) site(s) may be void or voidable.

Printed Name of Claimant _____ Signature of Claimant _____

*****FINAL ADJUDICATION*****

DATE 2/8/17 INITIALS AJ

AMC438326

LOCATION NOTICE FOR LODE MINING CLAIM

NOTICE IS HEREBY GIVEN that the BLACK GOLD

loade mining claim has been located by

GRE INC whose current mailing

address is 2091 E Murray Holladay Road Suite 22E, SLC, UT 84117.

The general course of this claim is NORTH TO SOUTH and it is

situated in COCHISE County, Arizona. This claim is 1500 feet in length and 600 feet in width. This claim runs from the location monument on which this location notice is posted approximately 750 feet in a NORTH direction to the NORTH end line and 750 feet in a SOUTH direction to the SOUTH end line. This claim is marked by six monuments, one at each corner and one at the center of each end line of the claim.

The location monument on which this notice is posted is situated within Section 21, Township 23S, Range 25E, Gila Salt River Base and Meridian, Arizona and this claim encompasses portions

of the following quarter section (s), section (s), Township (s) and Range (s) SW ¼ OF SECTION 21 T23S R25E

Gila Salt River Base and Meridian, Arizona.

The locality of this claim with reference to some natural object or permanent monument and additional information

(if any) concerning its locality are as follows: DISCOVERY MONUMENT IS LOCATED SOUTH 16° 47 MINUTES 49 SECONDS EAST, A DISTANCE OF 4,649 FEET FROM THE PERMANENT MONUMENT LOCATED AT THE NW CORNER OF SECTION 21 T23S R25E

This Notice of Location has been written to capture mineral rights within its boundaries, only on open and locatable ground. In the case that some or parts of the claim boundaries overlap private or patented land it is understood that no rights or ownership is implied or assumed in relation to that portion of the claim. In the case that any part of this claim boundary may overlap another, pre-existing claim, it is understood that no rights or ownership is implied or assumed in relation to that portion of the claim. Any overlap or overstaking that has occurred is solely due to standard sizing of claims and there is no claim or ownership implied or assumed.

DATED AND POSTED on the ground this 27TH day of MARCH, 2016.

LOCATOR (s) 

RECEIVED
BLM AZ STATE OFFICE
2016 MAY 19 P 2:55
PHOENIX, ARIZONA

BLM
Date
Stamp

AMC438326

MINING CLAIM MAP

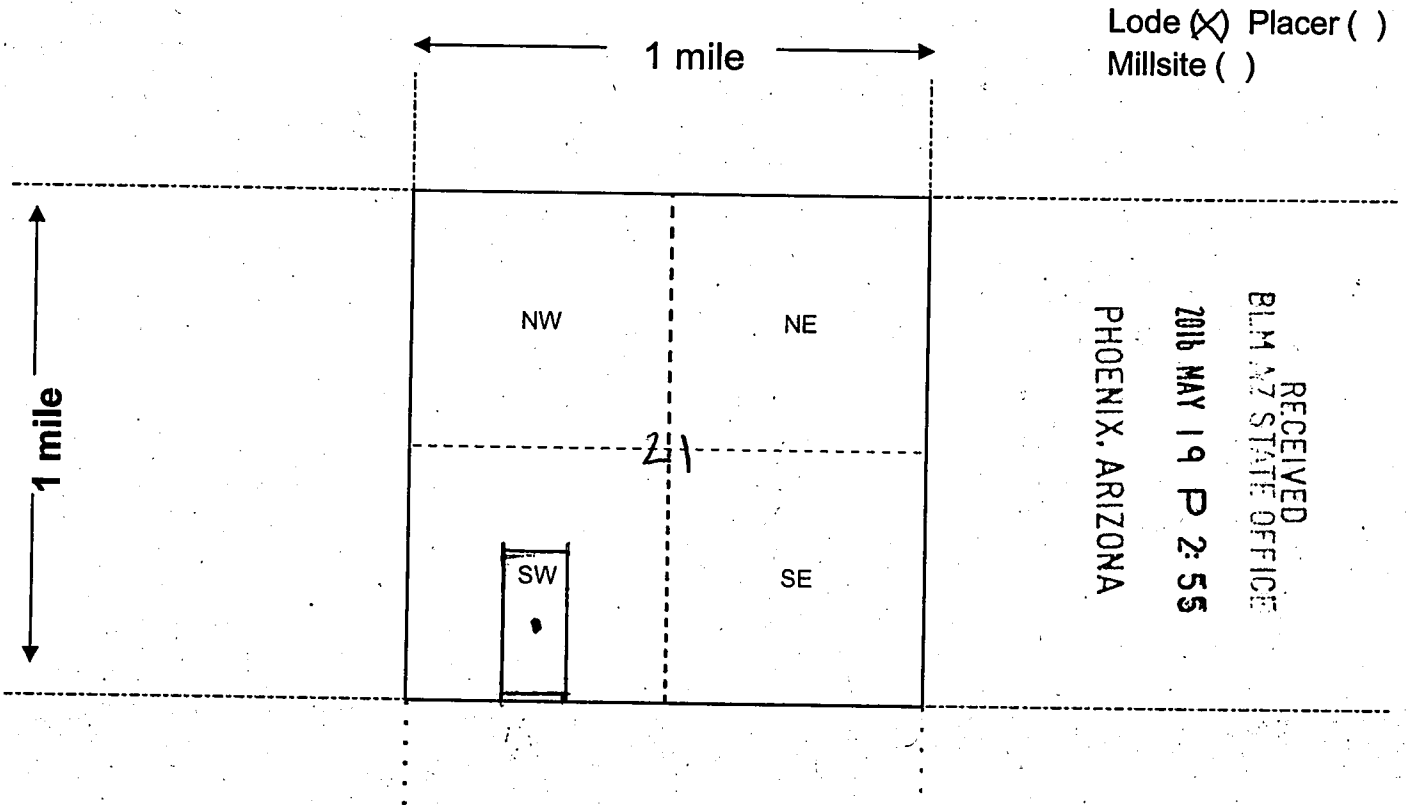

Scale: 1" = 2000 feet



AMC438326

- The above map depicts the Black Gold mining claim, which is located in Section (s) 21, Township 23 S, Range 25 E, Gila and Salt River Base and Meridian, Cochise County, Arizona. Total claim acreage is 20.66
- The type of corner and location monuments used are as follows: 2"X2" WOODEN STAKES WITH FLAGGING
- The bearings and distances in degrees and feet between claim corners and to a public land survey monument are as depicted on the map.
- If the claim is a placer or millsite claim with exterior limits conforming to legal subdivisions of the public survey, provide a legal description of the claim _____

Form MCF100a
Revised July 2014

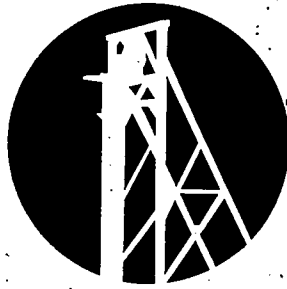

GOLD RUSH
EXPEDITIONS

5/12/2016

GRE, Inc.
2091 E. Murray Holladay Road
Suite #22E
SLC, UT 84117

ARIZONA BLM

Re: ONE Notice of Location(s)

Dear ARIZONA BLM Cashier,

Please find enclosed ONE Notice of location (s) for filing. I understand there is a fee for recording each of these documents. I have enclosed a check for the fees. Please apply the appropriate amount owed for filing fees and send a receipt with the recorded documents.

I have also enclosed a postage paid envelope for the document(s) to be returned.

Thank you for your time and efforts.

Sincerely,

GRE Accounting
385-218-2138
accounting@goldrushexpeditions.com
www.goldrushexpeditions.com

RUSH

PHOENIX, ARIZONA

2016 MAY 19 PM 2:55

RECEIVED
BLM AZ STATE OFFICE

AHC438326

DEPARTMENT OF INTERIOR
BUREAU OF LAND MANAGEMENT

Input Parameters for Geographic Report with Land

System Id = CR

Admin State = AZ

Geo State =

Casetype Begins With

Case Disp Txt = AUTHORIZED, CANCELLED, EXPIRED, PENDING, REJECTED, RELINQUISHED, WITHDRAWN

Mer Twp Rng =

Section =

Mtrs = 14 0230S 0250E 021, 14 0230S 0250E 999

Commodity =

Commodity Txt =

Pending Org =

Pend Org Decode =

Total Rows Returned: 0

CERTIFIED MAIL™



GOLD RUSH

EXPEDITIONS

2091 E. MURRAY HOLLADAY RD, STE. 22E

SALT LAKE CITY, UTAH 84117



7014 1200 0002 2188 9788



\$5.09 US POSTAGE
FIRST CLASS
000000001348
FROM 84117

RECEIVED
BLM AZ STATE OFFICE

2016 MAY 19 P 2:54

PHOENIX, ARIZONA

Arizona BLM
Attn: Cashier
One N. Central Ave., Ste. 800
Phoenix, AZ 85004